

max. width	W	max. 690 cm
max. length	L	max. 600 cm
max. area :		
Tube motor + gear		max. 10 m <sup>2</sup>
Linear actuator : Picolo		max. 18 m <sup>2</sup>
Econom		max. 30 m <sup>2</sup>
number of rack arms (minimum)	R	200 cm = 2 pcs
		201-360 cm = 3 pcs
		361-540 cm = 4 pcs
		541-690 cm = 5 pcs
rack arm distance	X	180 cm
slat side overhang	Y	40 cm
support distance	Z	
st. rack arm 35 mm		150 cm

scale 1:1

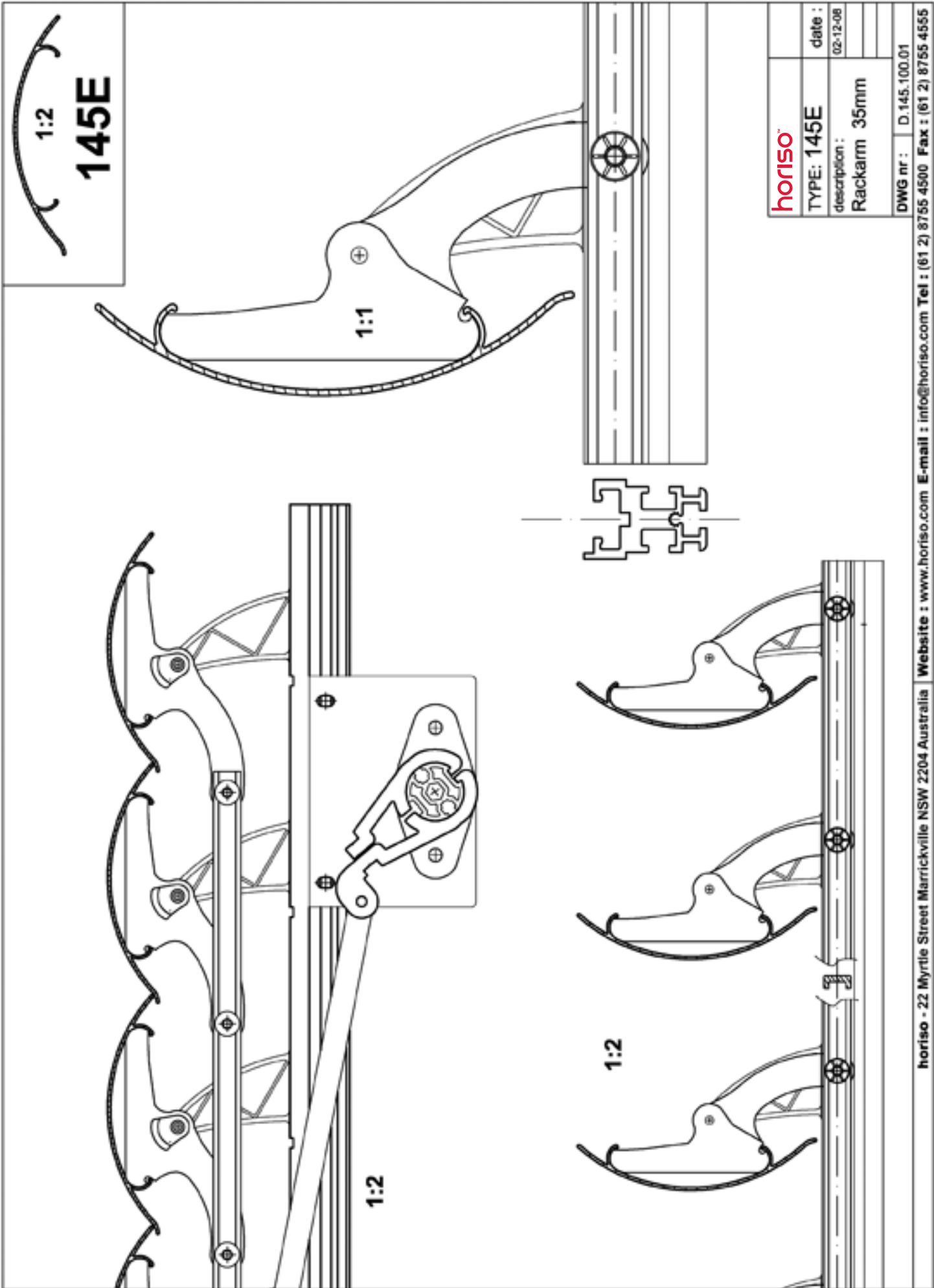

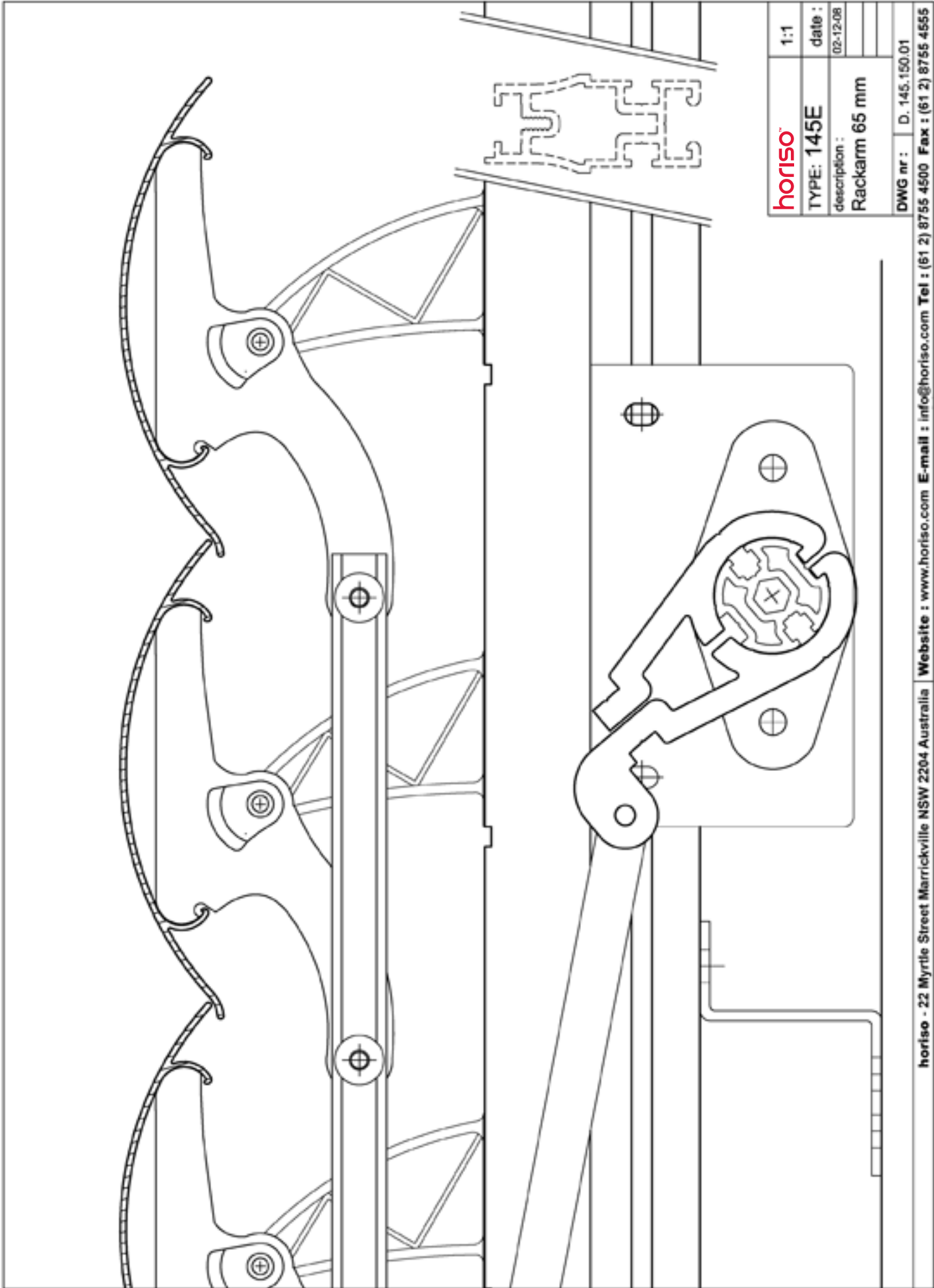

<b>horiso</b>	1:1
TYPE: 145E	date :
description :	02-12-08
Rackarm 65 mm	
DWG nr :	D. 145.150.01
horiso - 22 Myrtle Street Marrickville NSW 2204 Australia Website : www.horiso.com E-mail : info@horiso.com Tel : (61 2) 8755 4500 Fax : (61 2) 8755 4555	